

Updated Draft Site Plan



ROSS CHAPIN ARCHITECTS
PO Box 1555 • Langley, Washington 98040
T: (360) 929-9007 • E: ross@rosschapin.com • W: rosschapin.com



QAMAR & ASSOCIATES INC.
ARCHITECTURE AND TOWN PLANNING
3432 SE Carlton Street, Portland, Oregon 97202



#4 Mine Site
Roslyn, WA

8 October 2021

1.4

Site Plan

Possible Building Types

Use sticky notes to say what you like and dislike about the building types.



E2: Triplex row houses, 2BR, 2B each
or 3 over 3 six-plex w/1 BR, 1B each

FORTERRA

BUILDING TYPES



ROSS CHAPIN ARCHITECTS
PO Box 1995 • Langley, Washington 98260
T: (360) 929-9007 • E: ross@rosschapin.com • W: rosschapin.com



QAMAR & ASSOCIATES INC.
ARCHITECTURE AND TOWN PLANNING
3432 SE Carlton Street, Portland, Oregon 97202



#4 Mine Site

Roslyn, WA

20 July 2021

Concept Sketch

*Not final design. Will change with community input.

A Closer Look at the Draft Site Plan

Use sticky notes to say what you like and dislike about what you see.

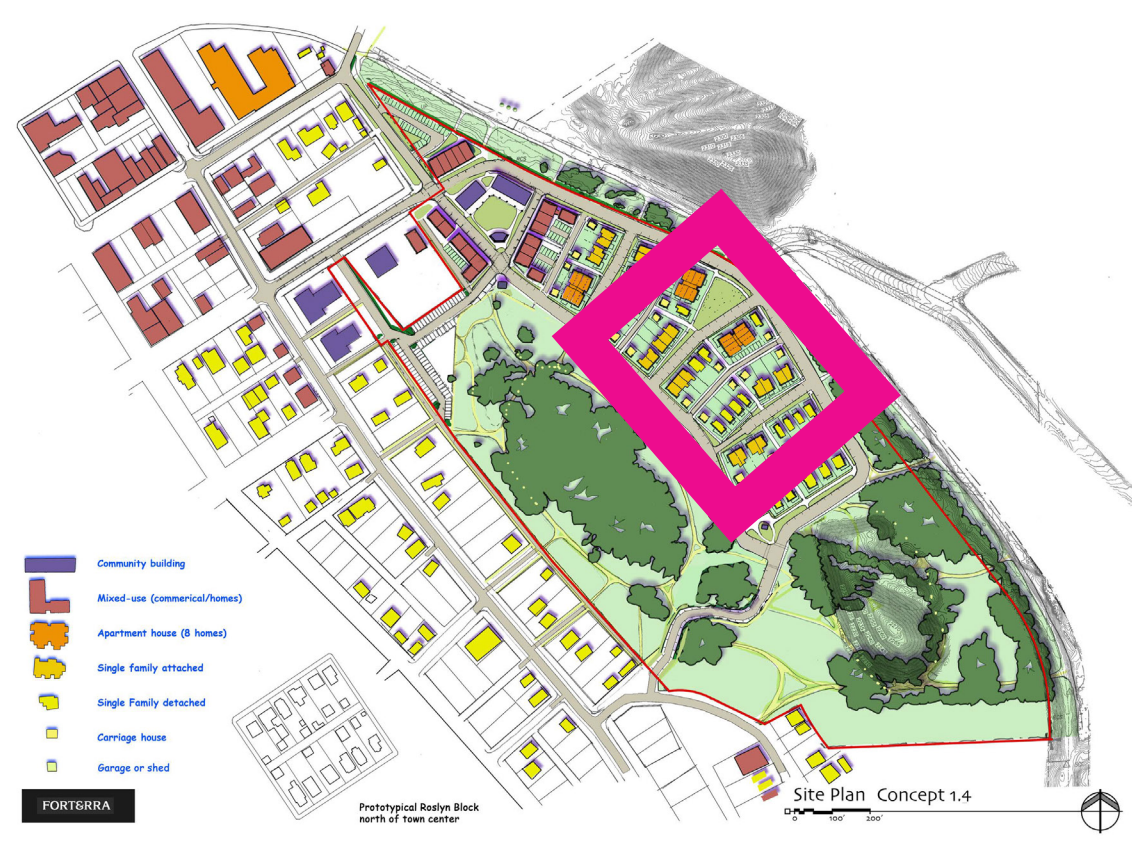
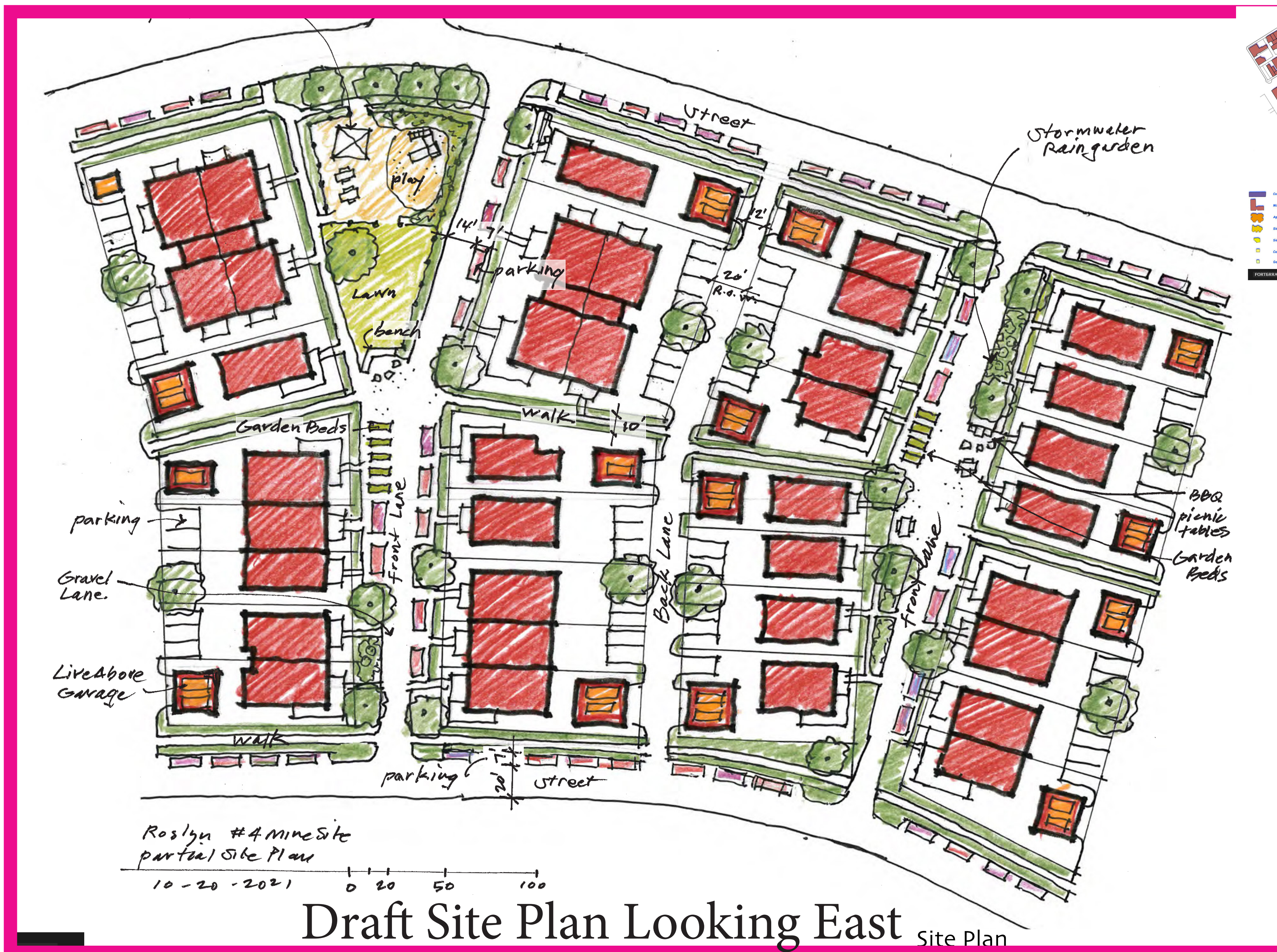

Perspective Looking West

*Not final designs. Will change with community input.